

Cadastral information derived from Land Information New Zealand's Digital Cadastral Database (DCDB). CROWN COPYRIGHT RESERVED. Digital Licence No. 133563-01.

<b>Map</b> <b>62</b> <b>Ashburton District</b>	<table border="1"> <tr><td></td><td>59</td></tr> <tr><td>62</td><td>63</td></tr> <tr><td>65</td><td>66</td></tr> </table>		59	62	63	65	66	<b>Ashburton District Plan</b> Scale: 1:5,095 at A3  May 2008 Prepared By: Computer Services Department, Ashburton District Council	<b>KEY</b> <b>Areas / Sites of Significant Nature Conservation Value</b> Group 1 (Green circle with 17) Group 2 (Green square with 17) Group 1, 2, 3, or 4 (Green circle with cross)	Class I, II & III Lands (Orange) Shelter Belt Areas (Green dotted) Scheduled Activities (Black dotted)	Heritage Items (House icon) Heritage and Notable Trees (Tree icon) Geopreservation Sites (Triangle icon)	Zone Boundary (Solid purple line) District Boundary (Dashed black line) High Voltage Transmission Lines (Red dashed line)	Altitudinal Land Use Line (900m a.s.l.) (Orange line) Extensions to the Altitudinal Land Use Line above 900 a.s.l. (Orange hatched)
		59											
62	63												
65	66												

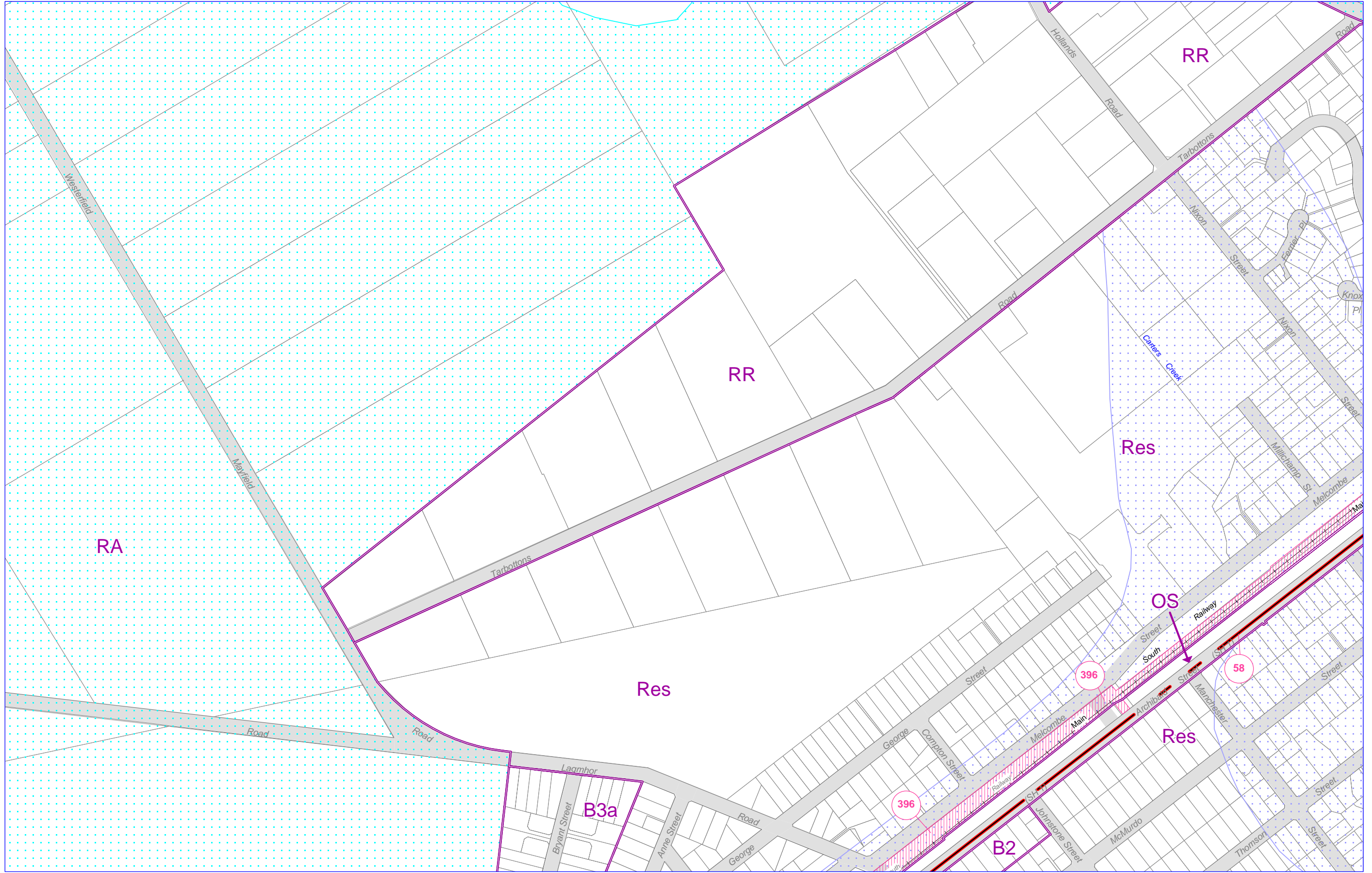

Cadastral information derived from Land Information New Zealand's Digital Cadastral Database (DCDB). CROWN COPYRIGHT RESERVED. Digital Licence No. 133563-01.

<b>Zones</b> B1 - Business 1    B5 - Business 5    RB - Rural B B2 - Business 2    B6 - Business 6    RC - Rural C B3a- Business 3a    B7 - Business 7    RES- Residential B3b- Business 3b    B8 - Business 8    RR - Rural Residential B3c- Business 3c    B9 - Business 9    TS - Township B3d- Business 3d    OS - Open Space    AQ - Aquatic Park B4 - Business 4    RA - Rural A		Areas of Outstanding Landscape Areas of Significant Landscape Designations	Zone Boundary District Boundary State Highway Designation	<b>Flooding</b> River Channels (High Risk) Adjoining Land (High Risk) Low Risk Residential Flood Areas	<b>KEY</b> All Legal Roads are Deemed to be Designated	<b>Ashburton District Plan</b> Scale: 1:5,095 at A3   Prepared By: Computer Services Department, Ashburton District Council May 2008	<table border="1"> <tr><td></td><td></td><td>59</td></tr> <tr><td></td><td>62</td><td>63</td></tr> <tr><td>65</td><td>66</td><td></td></tr> </table>			59		62	63	65	66		<b>Map 62</b> <b>Ashburton District</b>
		59															
	62	63															
65	66																